



# Speciality Doors

**VULCAN**  
INDUSTRIES LLC

[www.vulcanuae.com](http://www.vulcanuae.com)

# Contents

<b>Fire Rated &amp; Non Fire Rated Steel Doors</b>	<b>4</b>
<b>Forced Entry Doors</b>	<b>5</b>
<b>Bullet &amp; Blast Resistant Doors</b>	<b>6</b>
<b>Fire Rated Fully Glazed Double Doors with Side Transoms</b>	<b>7</b>
<b>Fire Rated Glazed Partitions</b>	<b>8</b>
<b>Fire Rated &amp; Non Fire Rated Wooden Doors</b>	<b>9</b>
<b>Acoustic Doors</b>	<b>10</b>
<b>Louver Doors</b>	<b>11</b>
<b>Sand Trap Louver Doors</b>	<b>12</b>
<b>X-Ray Protection Doors</b>	<b>13</b>
<b>Sliding Doors</b>	<b>14</b>
<b>Rolling Shutters</b>	<b>15</b>
<b>Loading &amp; Security Products</b>	<b>16</b>
<b>Frame Profiles</b>	<b>17</b>
<b>How to Order a Door?</b>	<b>18</b>

# ABOUT US

VULCAN INDUSTRIES LLC has been growing to become a substantial player in the Design and Fabrication of Fire Rated Doors & Security Doors. Targeting, urbanizing and high growth markets, VULCAN has a proven track-record of providing competitive, high-quality products specifically tailored to meet and surpass the requirements and demands of our customers. Our organic growth is further fuelled by an increased global demand for durable, superior quality products.

We are a one stop shop that provides clients a total package from consultation till installation of the final product. The raw materials used to manufacture our products are under strict selection from well-known manufacturers whose supplies undergo strict quality control and confirms to international standards. We have always believed in providing comprehensive, reliable and efficient pre-sales and after-sales services to our customers. Along with our own warehouses and transportation team, we have high caliber individuals in each area of expertise to achieve total customer satisfaction which is the core value that our organization stands behind.

**VULCAN products are designed to last –  
most are made to outlive the building**

## RECOGNITIONS & STANDARDS

Vulcan Industries LLC not only sets its quality in manufacturing & Services that we provide, but also in terms of recognition and standards that we have, which truly sets us apart from other quality producers.

### **Tested & Certified:**

Underwriters Laboratories (UL 10B & 10C in accordance with NFPA 252 & NFPA 80),  
Intertek (UL 10C)  
Warrington Fire (BS476 Part 22), the international certifications for our Fire Door assemblies  
(UL752), ASTM 3038

### **Approvals:**

In UAE - Approved by Abudhabi / Dubai / Ajman Civil Defence Authorities  
In Oman - RoP  
In Bahrain - Bahrain EDD

### **Standards:**

ISO 9001: 2015 Certified



## FIRE RATED & NON FIRE RATED STEEL DOORS

Vulcan's Fire rated steel doors are designed for all the residential, commercial and industrial applications. Vulcan Fire rated Steel Doors are made out of Double skinned galvanized steel with honeycomb or Rockwool Infill which provides insulation. Available in both Single and Paired Configurations. Vulcan fire rated steel doors provides a contractor friendly and cost effective means of Fire Protection. Fire Rating upto 180 Mins as per UL Standards & upto 240 Mins in BS Standards.

### SPECIFICATIONS

#### Frames

Frames are made out of high quality Steel. Steel frames could be made of different GI Sheet thicknesses 1.5mm/1.8mm/2.0mm. Vulcan Steel Frames carries high quality finish with its perfect welding techniques, which leaves with perfect corners, anchor bolt reinforcements. All Frames are manufactured with specified ironmongery reinforcements.

#### Shutters

Shutters are made out of GI Steel with standard/tested thickness of 1.2mm. Shutters are made with Honeycomb/Rockwool with Steel Stiffeners providing the thermal insulation.

GI Steel Frames & Shutters are powder coated as per customer specifications, in Textured/Glossy/Metallic/Wood Finishes.

#### Glazing

Door glazing could be provided as per the customer requirement or tested specifications with Georgian wired Glass or Clear Glass possessing fire rating properties with galvanized steel frames.

#### Hardware

Fire Rated/Tested Hardwares complying to UL/ANSI,BS/CE can be accommodated.

#### Tested & Certified

- ANSI/UL 10B – Fire Test Assemblies
- ANSI/UL10C – Positive Fire Test for Assemblies
- BS 476 P22 1987-Fire tests on building materials and structures. Method for determination of the fire resistance of non-loadbearing elements of construction.

### APPLICATIONS

Staircase, Electric rooms, Pump rooms, Corridors etc.

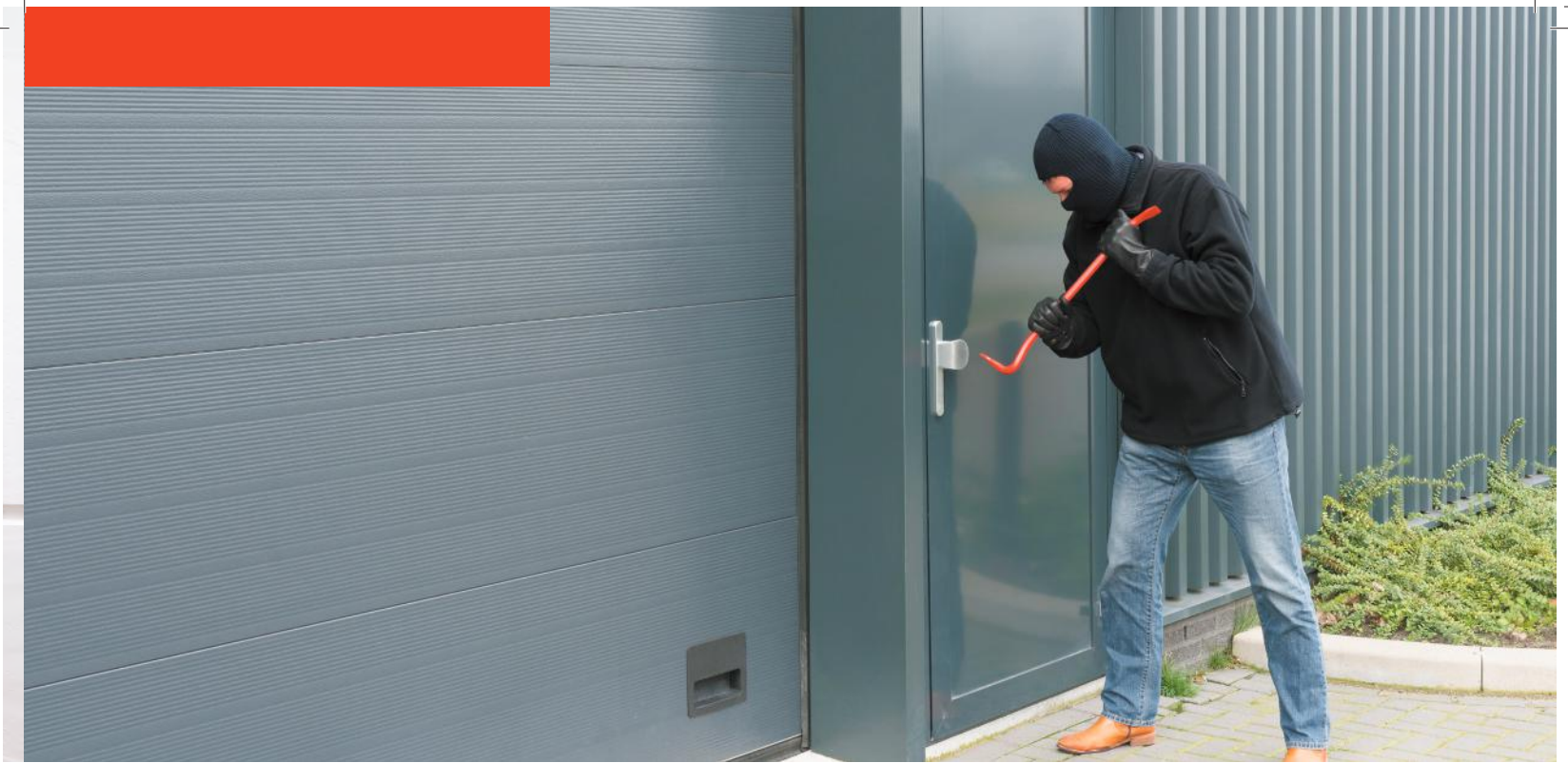

## FORCED ENTRY DOORS

Every building requires protection against forced entry - and doors & frames are the first line of defense. There are a number of motives for forced entry: Vandalism - Petty theft - Sophisticated burglary - Intent to harm individuals. Vulcan manufacture Security Doors according to the highest production standards and in compliance with special regulations. Doors are suitable for all building types-residential, commercial, institutional, security areas and for special purposes.

All the doors can be manufactured either in the stand alone ratings of Forced Entry, Fire Rating up to 3 hours as per ANSI UL 10C & Bullet Resistant as per UL 752 or combination ratings. All doors provide elevated threat protection solution compliant and third party tested & certified per stringent ASTM F3038 standards equivalent to US DOS SD-STD-01.01 (G) & HPW TP-0500.03.

### SPECIFICATIONS

#### Frame

Higher Gauge Thickness GI Sheet

#### Shutters

Higher Gauge Thickness GI Sheet

#### Hardwares

High Security Ironmongeries

#### Tested to

Tested in Accordance with ASTM F3038

### APPLICATIONS

Fire rated rolling shutter, Rolling shutter, Polycarbonate shutter, Sectional overhead door, Garage door



# BULLET & BLAST RESISTANT DOORS

Vulcan BR doors with an appearance of standard hollow metal product are secure from ballistic attack with and provides protection against assault and vandalism at vulnerable door openings. It is effective against a wide range of firearms bullets and shrapnel.

The bullet resistant system offers the absolute best protection against bullet penetration and fragmentation. Our BR doors are third party tested and certified per stringent UL 752 Level 3, 5 & 8 standards and comply to NIJ 3, US DOS SD-STD-02.01 Rifle AP.308 NATO M61, ASTM F 1233 7.21 M80 NATO, HPW TP 0500.02 Level D, DIN EN 1063 BR6, BS5051 BSI R2, AS/NZ 2343 R2, DIN 52-290 C5 SF and C5 SA.

## SPECIFICATIONS

### Blast Resistant Doors

Keep the same content in Catalogue draft.

### Frame

Higher Gauge Thickness GI Sheet.

### Shutters

Higher Gauge Thickness GI Sheet.

### Hardwares

High Security Ironmongeries

### Tested to

Bullet Resistant Doors - Tested in accordance with UL 752

## APPLICATIONS

Blast proof door, Bullet proof door

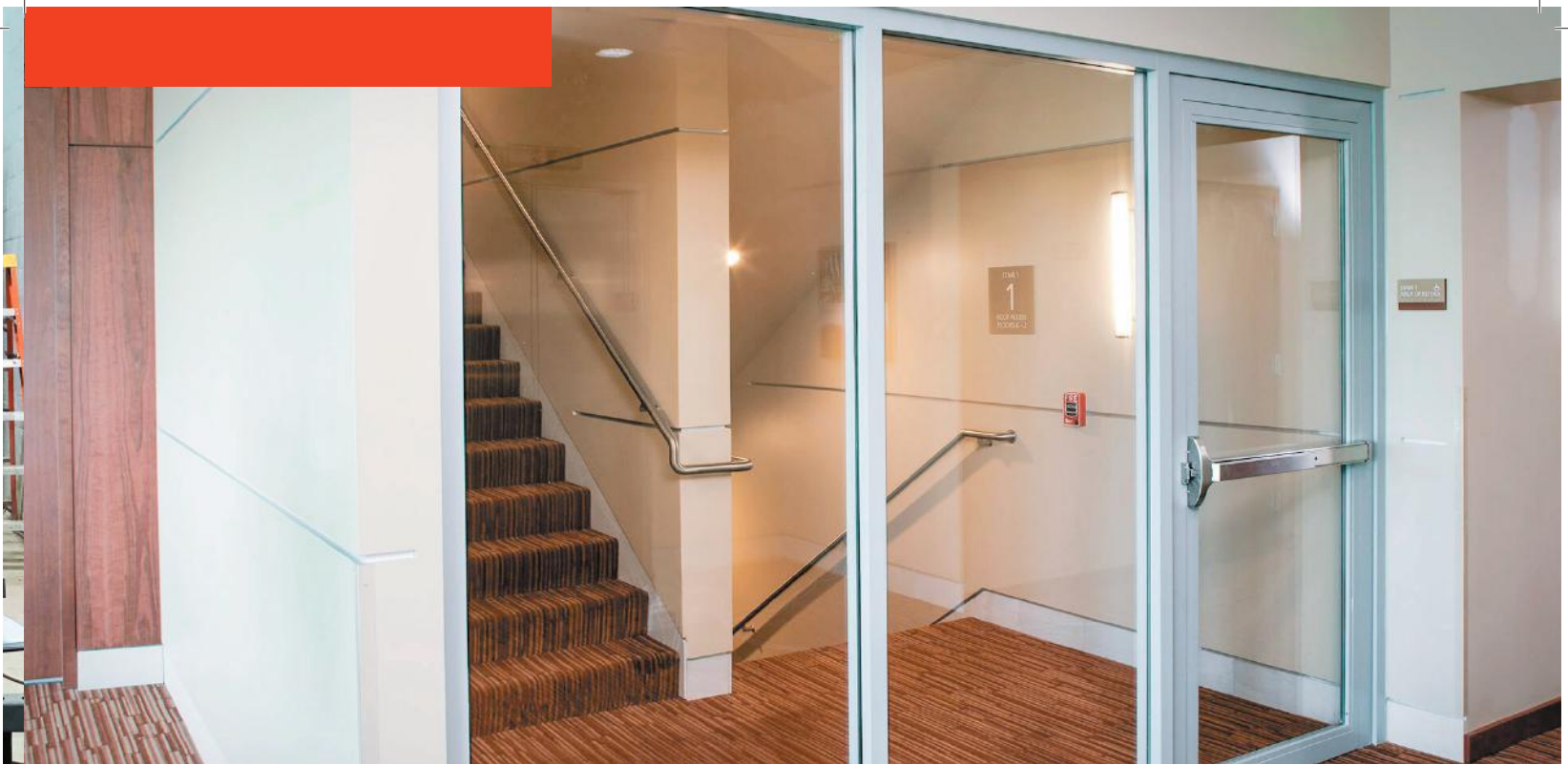

## FIRE RATED FULLY GLAZED DOUBLE DOORS WITH SIDE TRANSOMS

Fire rated Fully Glazed Double Doors are designed for use in both Commercial and residential areas. Glazed Doors provide appropriate lighting as well as fire safety and security. The use of fire resistant glazed doors in modern buildings allows light and vision, improving the user experience while protecting against the threat of fire. Fire rating upto 120 Mins.

### SPECIFICATIONS

#### Frames

Metal Frames are made out of high quality Steel. Steel frames could be made of different GI Sheet thicknesses 1.5mm/1.8mm/2.0mm. Vulcan Steel Frames carries high quality finish with its perfect welding techniques, which leaves with perfect corners, anchor bolt reinforcements. All Frames are manufactured with specified ironmongery reinforcements.

#### Glazing

Tested & Certified Fire Rated Glasses with appropriate glazing system is used for Glazed Doors

#### Shutters

- Shutters are made out of GI Steel with standard/ tested thickness of 1.2mm. Shutters are made with Honeycomb/Rockwool with Steel Stiffeners providing the thermal insulation.
- GI Steel Frames & Shutters are powder coated as per customer specifications, in Textured/Glossy/Metallic/ Wood Finishes.

#### Tested to

BS 476 P22 1987-Fire tests on building materials and structures. Method for determination of the fire resistance of non-loadbearing elements of construction.  
EN 1364-1:2015, Fire Resistance Tests for non-load bearing elements-Part 1: walls

### APPLICATIONS

High security areas

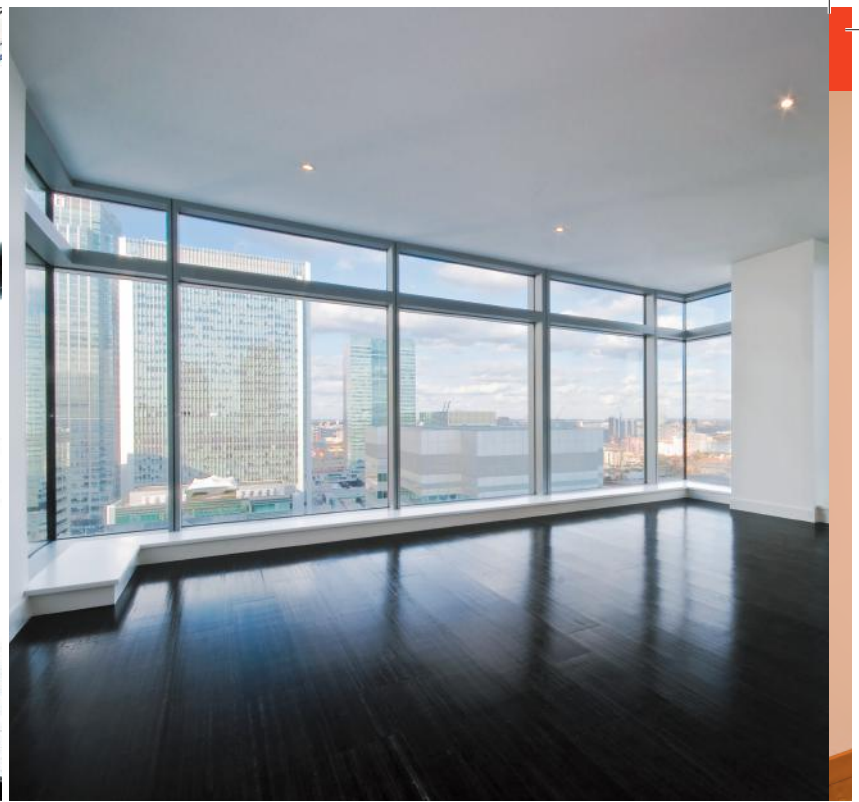

## FIRE RATED GLAZED PARTITIONS

Fire rated glazed partitions are designed for use in both Commercial and residential areas. Glazed Partitions provide appropriate lighting as well as fire safety and security. The use of fire resistant glazing in modern buildings allows light and vision, improving the user experience while protecting against the threat of fire. Vulcan Fully Glazed Steel partitions having an Integrity rating of 90 Mins & Sustainable flaming with 110Mins.

### SPECIFICATIONS

#### Frames

Metal Frames are made out of high quality Steel. Steel frames could be made of different Gl Sheet thicknesses 1.5mm/1.8mm/2.0mm. Vulcan Steel Frames carries high quality finish with its perfect welding techniques, which leaves with perfect corners, anchor bolt reinforcements. All Frames are manufactured with specified ironmongery reinforcements.

#### Glazing

Tested & Certified Fire Rated Glasses with appropriate glazing system is used for Glazed Partitions.

#### Tested to

BS 476 P22 1987-Fire tests on building materials and structures. Method for determination of the fire resistance of non-loadbearing elements of construction.

EN1363-1: 2012: Fire Resistance Tests –part 1: General Requirements

EN1363-2 2000: Fire Resistance Tests –part 1: Alternative & Additional Procedures

EN1363-1 2015: Fire Resistance Tests for non-load bearing elements-Part 1: walls

### APPLICATIONS

Shopping malls, Office partitions





# FIRE RATED & NON FIRE RATED WOODEN DOORS

Vulcan Fire Rated and Non Fire Rated Wooden Doors are designed for use in residential & commercial Applications. Wooden Doors are applicable in both single & Paired Configurations. Wooden Doors are mainly used in the interiors. Different species of Hardwoods, Veneers are used to provide unique finishes to the doors. Other means of finishes such as Laminate and paint also can be used. Our Wooden Doors can achieve acoustic rating upto 35dB. Vulcan Fire Rated are available from 30 Mins to 120 Mins Fire rating as per BS Standards & upto 90 Mins in UL Standards.

## SPECIFICATIONS

### Frames

Frames are made with Solid Hardwood of density varying from 600kg-800kg/ m<sup>3</sup> depending upon the fire rating & specification requirements. For Fire rated doors frames would be equipped with intumescent protection. Frames can be polished and painted.

### Hardware

Fire Rated/ Tested Hardware complying to UL/ANSI, BS/CE can be accommodated.

### Shutters

Fire Rated Shutters are made with 3 layered Particle Chip Boards, 5 Ply Proprietary Blanks & Composite Blanks which has been tested & certified. Non fire rated shutters can be made with Hollow core, Solid Chip board, Semi solid Door Blanks. Door thickness varying from 35mm to 44mm in NFR and 44mm to 64mm are available depending on the fire rating requirements. Shutter finishes can be Wood Veneered & polished, Laminated and painted.

### Tested to

- BS 476 P22 1987-Fire tests on building materials and structures. Method for determination of the fire resistance of non-loadbearing elements of construction.
- CAN4 S104 (1985): NFPA 252 (2008): UL 10(c) (2001): UL 10(c) (2009): CAN / ULC S104
- (2010): NFPA 252 (2012)

## APPLICATIONS

Room entrance, Interior doors, Office, Pantry, WC.



## ACOUSTIC DOORS

Acoustic doors basically act like sound barriers. They are widely used in cinemas and theatre complexes, recording studios, night clubs etc. to complement other sound proofing techniques. These days all doors are expected to have a minimum acoustic property to cut down general noise just like walls. The doors are rated based on the sound that they prevent from passing through them. The rating is in dB (decibels) or STC (Sound Transmission Class). Acoustic doors are made in accordance with BS EN ISO 140: Part 3: 1995.

### SPECIFICATIONS

#### Frames

- Wood Frames are made with Solid Hardwood of density varying from 600kg-800kg/m<sup>3</sup> depending upon the fire rating & specification requirements. For Fire rated doors frames would be equipped with intumescent protection. Frames can be polished and painted.
- Metal Frames are made out of high quality Steel. Steel frames could be made of different GI Sheet thicknesses 1.5mm/1.8mm/2.0mm. Vulcan Steel Frames carries high quality finish with its perfect welding techniques, which leaves with perfect corners, anchor bolt reinforcements. All Frames are manufactured with specified ironmongery reinforcements.
- Frames would be equipped with required acoustic Seals as per the dB ratings.

#### Hardwares

Fire Rated/Tested Hardwares complying to UL/ANSI, BS/CE can be accommodated.

#### Shutters

Fire Rated Shutters are made with 3 layered Particle Chip Boards, 5 Ply Proprietary Blanks & Composite Blanks which has been tested & certified. Non fire rated shutters can be made with Hollow core, Solid Chip board, Semi solid Door Blanks. Door thickness varying from 35mm to 44mm in NFR and 44mm to 64mm are available depending on the fire rating requirements. Shutter finishes can be Wood Veneered & polished, Laminated and painted. Acoustic rating achievable upto 35dB.

Shutters are made out of GI Steel with standard/ tested thickness of 1.2mm. Shutters are made with Honeycomb/Rockwool with Steel Stiffeners providing the thermal insulation. GI Steel Frames & Shutters are powder coated as per customer specifications, in Textured/Glossy/Metallic/Wood Finishes. Acoustic rating achievable upto 47dB.

Shutters would be equipped with required acoustic Seals as per the dB ratings.

### APPLICATIONS

Theatres, Auditoriums, Recording studios, Halls etc.



# LOUVER DOORS

Louvered doors are installed in places where ventilation is a criteria. Usually in areas where heat dissipation is a must, these doors provide a passage for air, but no visibility. The louvers can be of different sizes from small units on the top or bottom of doors to almost the entire door size. Since louvers provide a passage for air, which means they provide a passage for fire and hence “on their own” are not fire rated. Fire rated louvers are available which can be installed on fire doors to make the unit fire rated. These louvers have movable flaps which close in the event of a fire due to a fusible link closing a passage for flames.

## SPECIFICATIONS

### Frames

Wood Frames are made with Solid Hardwood of density varying from 600kg-800kg/m<sup>3</sup> depending upon the fire rating & specification requirements. For Fire rated doors frames would be equipped with intumescent protection. Frames can be polished and painted.

Metal Frames are made out of high quality Steel. Steel frames could be made of different GI Sheet thicknesses 1.5mm/1.8mm/2.0mm. Vulcan Steel Frames carries high quality finish with its perfect welding techniques, which leaves with perfect corners, anchor bolt reinforcements. All Frames are manufactured with specified ironmongery reinforcements.

### Hardware

Fire Rated/Tested Hardwares complying to UL/ANSI, BS/CE can be accommodated.

### Shutters

Fire Rated Shutters are made with 3 layered Particle Chip Boards, 5 Ply Proprietary Blanks & Composite Blanks which has been tested & certified. Non fire rated shutters can be made with Hollow core, Solid Chip board, Semi solid Door Blanks. Door thickness varying from 35mm to 44mm in NFR and 44mm to 64mm are available depending on the fire rating requirements. Shutter finishes can be Wood Veneered & polished, Laminated and painted.

Shutters are made out of GI Steel with standard/ tested thickness of 1.2mm. Shutters are made with Honeycomb/Rockwool with Steel Stiffeners providing the thermal insulation. GI Steel Frames & Shutters are powder coated as per customer specifications, in Textured/Glossy/Metallic/Wood Finishes.

## APPLICATIONS

Fire rated louver doors, Pump rooms, Server rooms



# SAND TRAP LOUVER DOORS

Vulcan Sand Trap Louver Doors are ideal doors for locations where natural ventilation is required and at the same time probability of dust accumulation is also high. Isolated & windy areas where substations & transformers are required Vulcan sandtrap louvers are the best solution in the market. Available in Single or Double panel configuration with frames prepared for installation in Masonry or Steel Construction. Vulcan Sand Trap Louver Doors are strong & rigid in construction & applicable for both industrial & commercial purposes. Our doors are designed to separate intake air from sand & dust particles from intake air for ventilation purposes. Hung by heavy-gauge steel hinges with available hardware configurations like custom made all drops and tower bolts. Louvers and frames are constructed of galvanised steel. Vulcan can also build to fit your specific needs in custom door sizes and configurations of hardware.

## SPECIFICATIONS

### Frames

Normally constructed with 1.5 mm thick galvanised steel & can go upto 3 mm as per requirements.

### Shutters

Normally constructed with 1.2 mm thick galvanised steel & can go upto 3mm as per requirements.

### Louvers

Normally constructed with 1.2 mm thick galvanised steel & can go upto 2 mm as per requirements. They are also provided with holes to empty the filtered sand that is accumulated.

### Hardware

- Custom made hardware like alldrops & tower bolts are possible.
- Any customer specific locking can also be engineered into Vulcan Doors. Bird screens and fly screens are additional options available with Vulcan Sand Trap Louver Doors.
- Approved by Kharamah.

## APPLICATIONS

Transformer room doors, Substation doors



## X-RAY PROTECTION DOORS

Vulcan X Ray Protection Doors are designed to meet the requirements of NCRP (National Council on Radiation Protection) for use in Industrial & Hospital applications. X ray Doors provides a safe environment for hospital workers as well as industrial operators, thus mini-missing radiation exposure to individuals.

Available in Single, Double panel or Sliding configuration, Vulcan Doors are designed to suit custom requirements based on the amount of radiation present in the area. Vulcan can also build to fit your specific needs in custom door sizes, designs and configurations of hardware. Both steel & wooden doors are tailor made to suit various customer & project requirements.

### SPECIFICATIONS

#### Frames

- Wooden Frames are made with high density solid wood & then lined with lead (1 mm - 6 mm thick) based on the radiation count.
- Steel frames are made with 2 mm to 3 mm thick galvanised steel & lead lined behind the frames in order to arrest radiation leakage.

#### Shutters

Wooden Shutters are made with particle chip board, mineral core and composite cores. They are then lined with lead (1 mm - 6 mm thick) based on the radiation count.

Steel Doors are made with 1.5 mm - 2.5 mm thick galvanised steel as outer skin, infill being rockwool and then lead lined (1 mm - 6 mm thick).

#### Hardware

- Fire rated hardware complying to ANSI & British standards can be accommodated.
- Security hardware starting from the range of single point locking to five point locking system is also available.
- Any customer specific lock system can also be engineered into Vulcan Doors.
- Sliding Mechanisms can be manual as well as automatic with motorised controls. Depending on the radiation count lead line sealings are taken into account.

### APPLICATIONS

X-Ray rooms, Radiation room

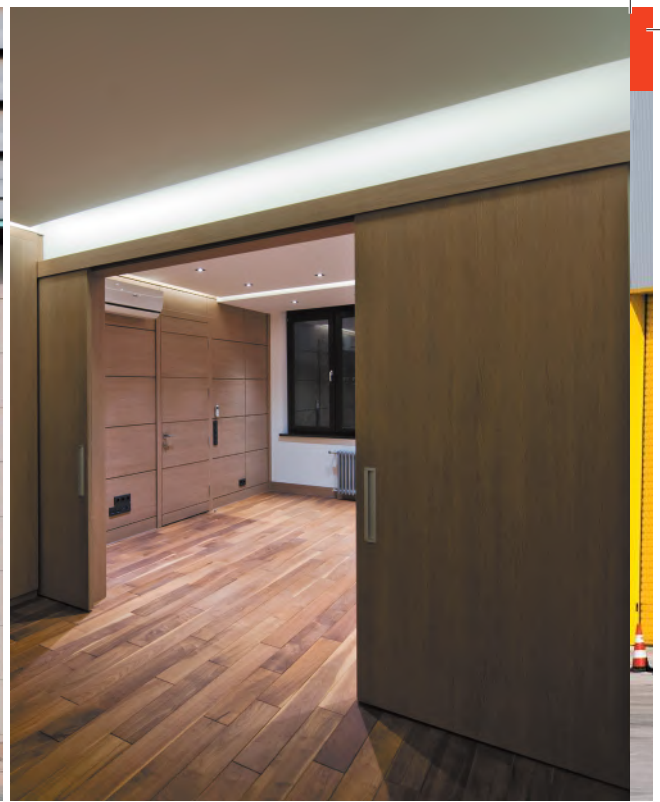

## SLIDING DOORS

Sliding doors have a few functionalities. Space constraints are usually the reason behind placement of these doors but aesthetic appeal also plays a major role at times. Glazed sliding doors are widely used in commercial and residential buildings and entrances and are more an interior design item than a functional requirement.

The doors are manufactured similar to our standard fabrication techniques with runners fixed on channels at the bottom and rails with bearings on the top of the door. Frames are ideally overhead rails on which the doors are hung and can be used for single or double run applications. Floor channels are also part of the assembly which can be fixed by screws or incorporated in concrete.

### SPECIFICATIONS

#### Sliding Shutters

Wooden shutters are made with hollow core or various other cores depending on site requirements. Steel doors are made with 1.2mm-1.5mm thick galvanised steel as outer skin, infill being rockwool or honey comb.

#### Hardware

Sliding Mechanisms can be manual as well as automatic with motorised controls. Depending on the security requirements sliding doors can be designed to achieve concealed mechanisms so that the security & aesthetics are not compromised.

### APPLICATIONS

Office corridors, Portable offices, Ware house entrance



## ROLLING SHUTTERS & SECTIONAL OVERHEAD DOORS (BRAND-MIACASA)

We are the UL listed manufacturer for 3 hour fire rated single skin rolling shutters. MC-777. We provide all kinds of rolling shutters and sectional overhead doors for commercial and residential uses. Miacasa Roller shutter doors are suitable for a variety of applications from small security shutters to large warehouse doors. We install strong and efficient roller shutters to withstand the toughest conditions providing reliability whilst retaining ease of operation. They are normally operated by a geared hand chain hoist or an electric motor.

Sectional Overhead doors are the perfect solution for commercial and production facilities. They have heavy duty design and can be adapted to any existing structure. Special technologies ensures the doors have a long service life and operate without faults. The Doors Have Special Structural elements which increase their reliability and durability. A reliable seal system ensures increased thermal insulation which helps to maintain temperature control and save energy.

### SPECIFICATIONS

Sectional doors mainly comes in two types

- Sectional overhead for residential purpose (Garage Doors)
- Sectional overhead for Industrial purpose.

### APPLICATIONS

Fire rated rolling shutter, Rolling shutter, Polycarbonate shutter, Sectional overhead door, Garage door

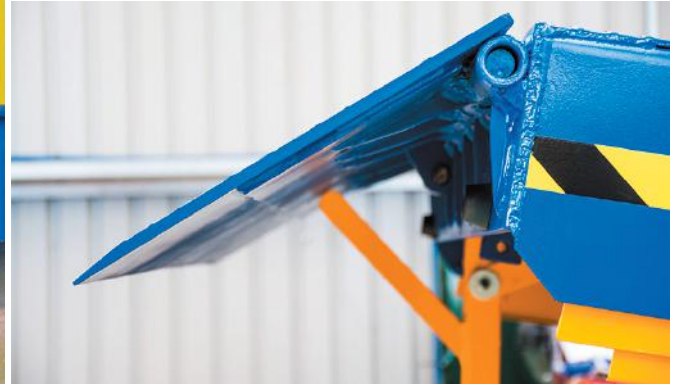

## LOADING & SECURITY PRODUCTS (BRAND-MIACASA)

In a much physical & laborious situations when handling of heavy loads becomes really painful & time taking during the loading & unloading of the material. The smartest way is to equip your loading bays with efficient & time saving loading bay material handling equipment. Miacasa loading equipment solutions reduce your efforts of loading. These would enhance safety and productivity on the dock through variety of design features.

Miacasa provides a full range of docking solutions for loading and unloading of goods, consists of Docklevelers, Drawbridges, Dock shelters, Dock House, Scissor lifts.

### APPLICATIONS

Dock leveller, Dock shelter, Traffic barrier, Bollards



# FRAME PROFILES

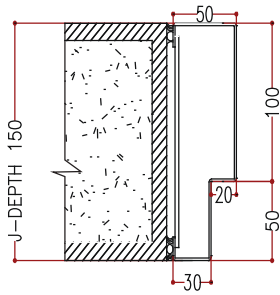

SRF-SINGLE REBATE FRAME

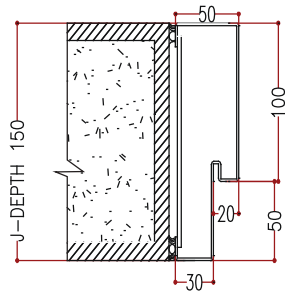

RGSRF-RUBBER GROOVED SINGLE REBATE FRAME

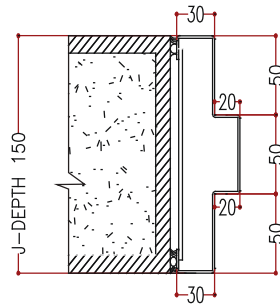

DRF-DOUBLE REBATE FRAME

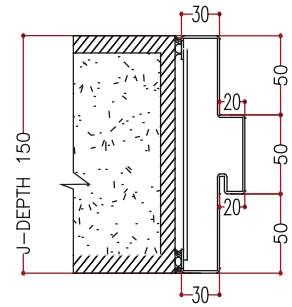

RGDRF-RUBBER GROOVED DOUBLE REBATE FRAME

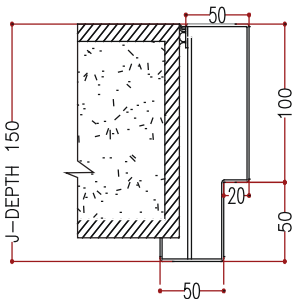

SASRF-SINGLE ARCHITRAVE SINGLE REBATE FRAME

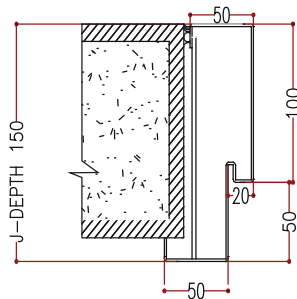

RGSASRF-RUBBER GROOVED SINGLE ARCHITRAVE SINGLE REBATE FRAME

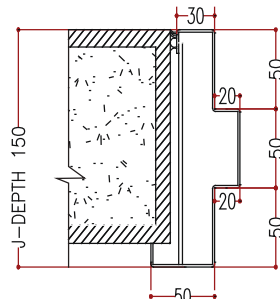

SADRF-SINGLE ARCHITRAVE DOUBLE REBATE FRAME

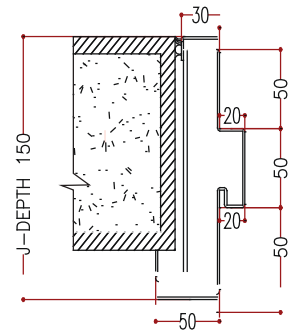

RGSADRF-RUBBER GROOVED SINGLE ARCHITRAVE DOUBLE REBATE FRAME

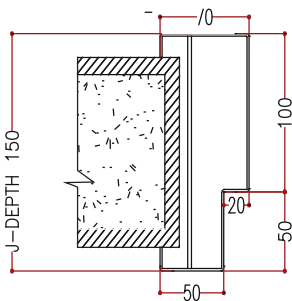

DASRF-DOUBLE ARCHITRAVE SINGLE REBATE FRAME

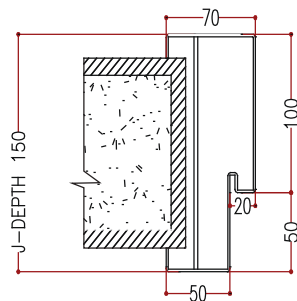

RGDASRF-RUBBER GROOVED DOUBLE ARCHITRAVE SINGLE REBATE FRAME

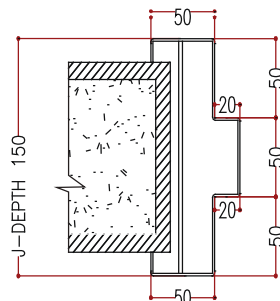

DADRF-DOUBLE ARCHITRAVE DOUBLE REBATE FRAME

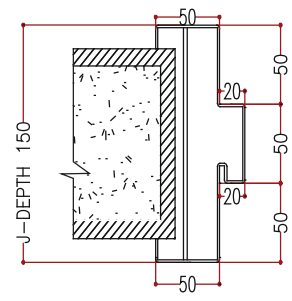

RGDADRF-RUBBER GROOVED DOUBLE ARCHITRAVE DOUBLE REBATE FRAME

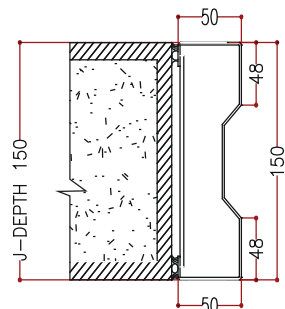

DSF-DOUBLE SWING FRAME

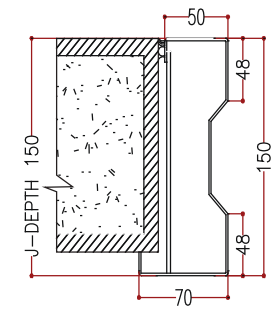

SADRF-SINGLE ARCHITRAVE DOUBLE SWING FRAME

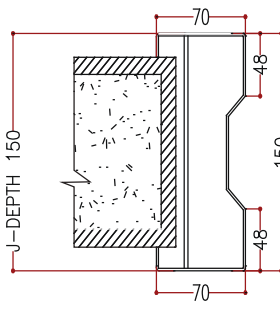

DADSF-DOUBLE ARCHITRAVE DOUBLE SWING FRAME

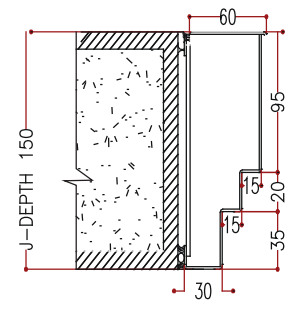

DEF-DOUBLE EGRESS FRAME

# HOW TO ORDER A DOOR?

## A SIMPLE 4 STEP ORDERING PROCESS

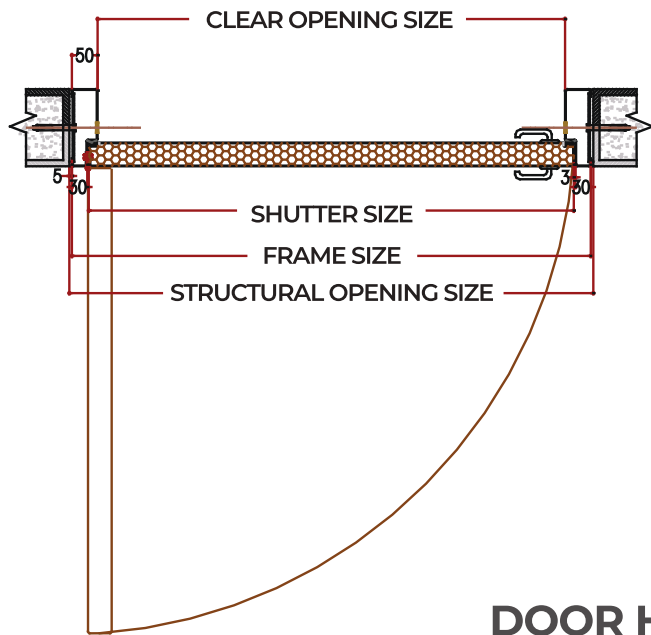

### DIMENSION TERMINOLOGY

1. Chose a frame profile
2. Fix your dimensions
3. Chose the required dirction
4. Chose your required colour

### DOOR HANDING

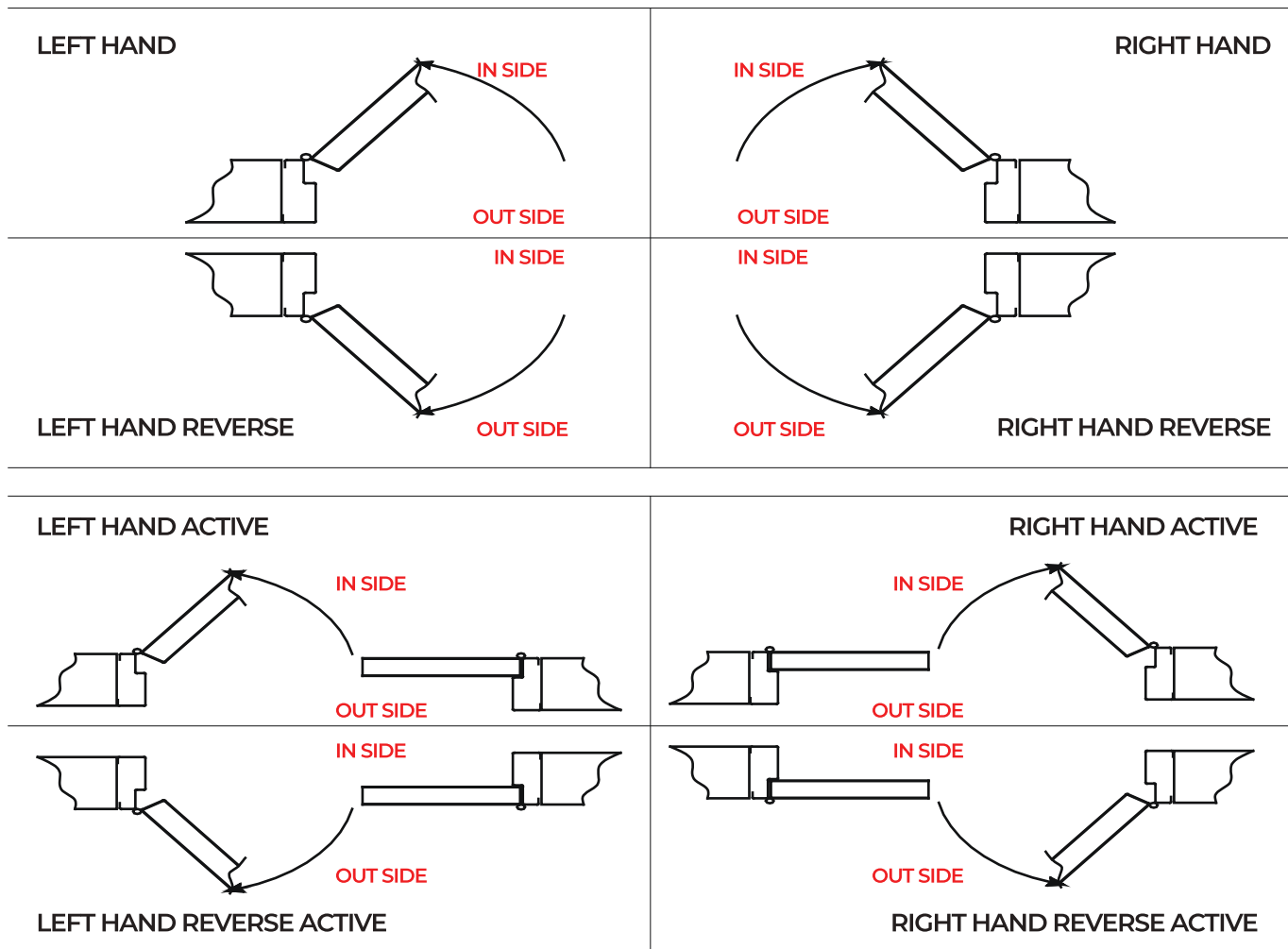





**VULCAN**  
INDUSTRIES LLC

**Your Passive Fire Protector**

Ajman Factory & Office  
PO Box 15007, Ajman, UAE  
T: +971 6 7436665  
F: +971 6 7437033  
M: +971 50 6287115  
[info@vulcanuae.com](mailto:info@vulcanuae.com)

[www.vulcanuae.com](http://www.vulcanuae.com)

